

Hand brakes, brake handles & release handles

Hand brakes in aluminium

Hand brakes in steel

Brake and release handles

Brake handles

Release handles

Hand brakes – aluminium

B1 – Brake with push to brake function and single bend brake lever

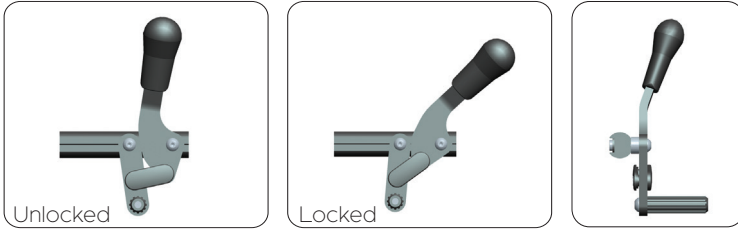

| Description | Part. no. right | Part. no. left |
|-------------|-----------------|----------------|
| Black | 673061-R1 | 673062-L1 |

» Spring-loaded

B2 – Brake with push to brake function and double bend brake lever

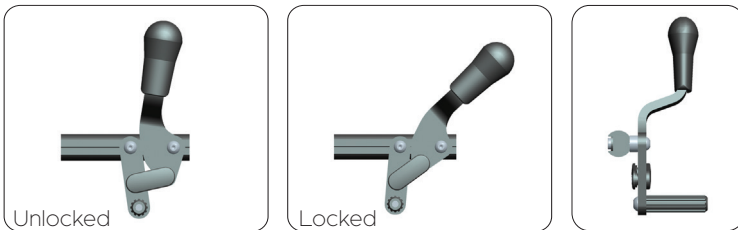

| Description | Part. no. right | Part. no. left |
|-------------|-----------------|----------------|
| Black | 673063-R1 | 673064-L1 |

» Spring-loaded

B3 – Brake with push to brake function and single bend brake lever

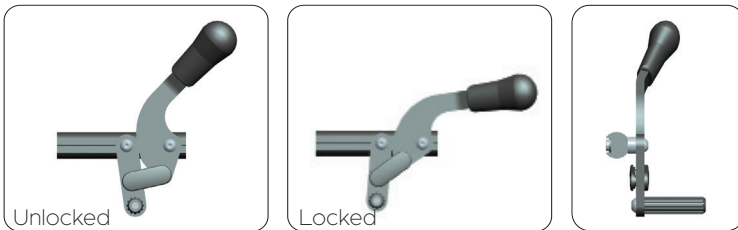

| Description | Part. no. right | Part. no. left |
|-------------|-----------------|----------------|
| Black | 673065-R1 | 673066-L1 |

» Spring-loaded

B4 – Brake with push to brake function and double bend brake lever

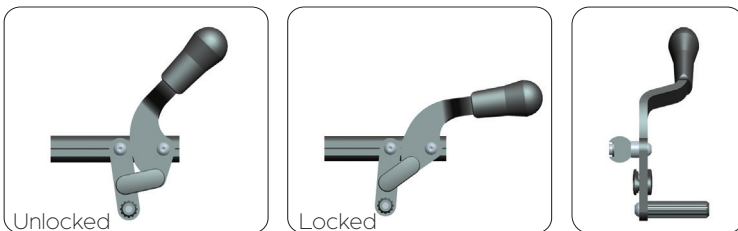

| Description | Part. no. right | Part. no. left |
|-------------|-----------------|----------------|
| Black | 673067-R1 | 673068-L1 |

» Spring-loaded

B5 – Brake with pull to brake function and single bend brake lever

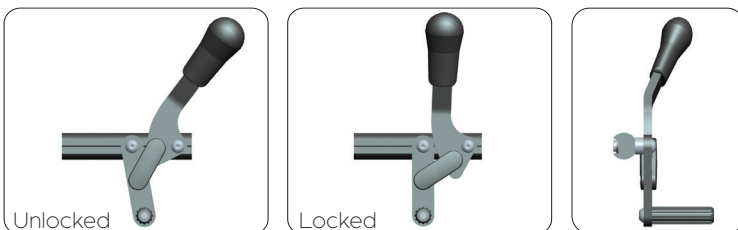

| Description | Part. no. right | Part. no. left |
|-------------|-----------------|----------------|
| Black | 673069-R1 | 673070-L1 |

» Spring-loaded

B6 – Brake with pull to brake function and double bend brake lever

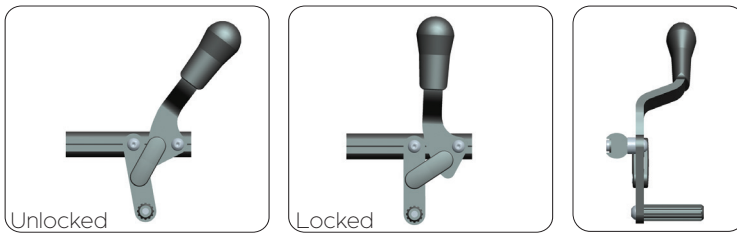

| Description | Part. no. right | Part. no. left |
|-------------|-----------------|----------------|
| Black | 673071-R1 | 673072-L1 |

» Spring-loaded

B8 – Brake for people with limited strength with push to brake function and double bend brake lever

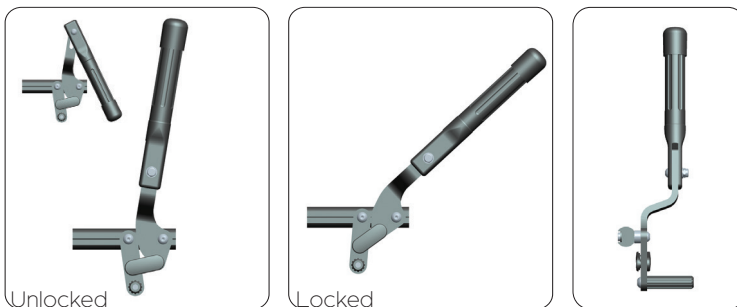

| Description | Part. no. right | Part. no. left |
|-------------|-----------------|----------------|
| Black | 673075-R1 | 673076-L1 |

» Spring-loaded

Hand brakes – steel

B9 – Brake with push to brake function and single bend brake lever

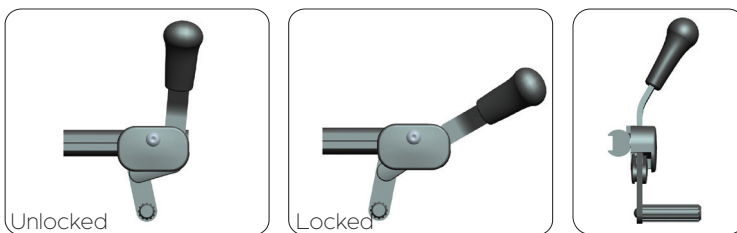

| Description | Part. no. right | Part. no. left |
|-------------|-----------------|----------------|
| Black | 673077-R1 | 673078-L1 |

» Spring-loaded

B10 – Brake with push to brake function and double bend brake lever

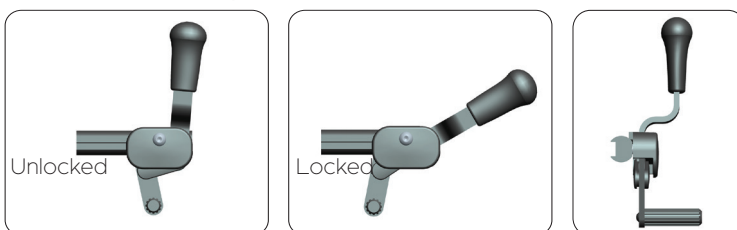

| Description | Part. no. right | Part. no. left |
|-------------|-----------------|----------------|
| Black | 673079-R1 | 673080-L1 |

» Spring-loaded



MS 24" x 1 3/8" - (37-540) C-28

Extension levers

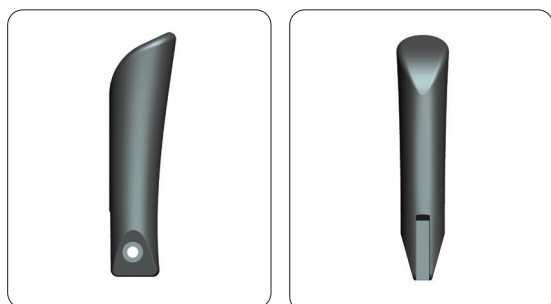

Extension levers for MBL hand brakes

- » Ergonomic shape
- » Foldable which gives easy transfer in and out of the chair
- » Reduce the needed brake force on the brake handle
- » Available in 2 different lengths
- » Available for brakes with both 4mm and 6mm lever.
- » Nice elegant design
- » Material: Black PA+GF

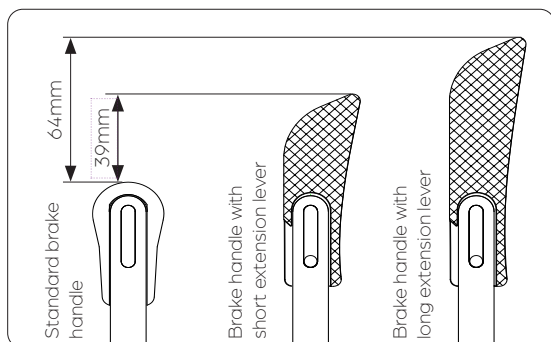

| Description | Part. no. right side | Part. no. left side |
|--|----------------------|---------------------|
| Extension lever for alu brakes (Short) | 673219 | 673216 |
| Extension lever for alu brakes (Long) | 67321A | 673217 |
| Extension lever for steel brakes (Short) | 67321G | 673213 |
| Extension lever for steel brakes (Long) | 673218 | 673214 |



< Brake handle with short extension lever

Brake handle with long extension lever >

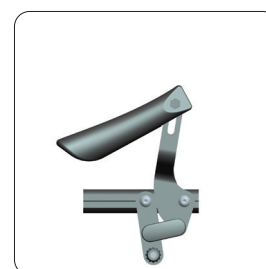
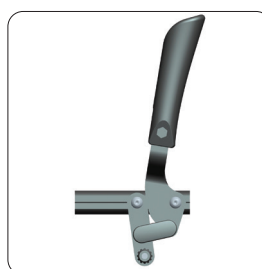

Mounting clamps



Mounting clamp – black aluminium

| Description | Part. no. Black |
|--|-----------------|
| Complete mounting clamp for fitting brake on tube - Ø19/Ø20 mm | 674005 |
| Complete mounting clamp for fitting brake on tube - Ø19/Ø22 mm | 674004 |
| Complete mounting clamp for fitting brake on tube - Ø19/Ø25 mm | 674001 |
| Complete mounting clamp for fitting brake on tube - Ø19/Ø30 mm | 674003 |

Handles – intro

Self-locking parking brake function

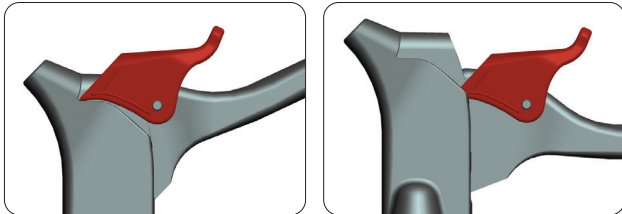

The stop lever pushes down automatically

Manual parking brake function

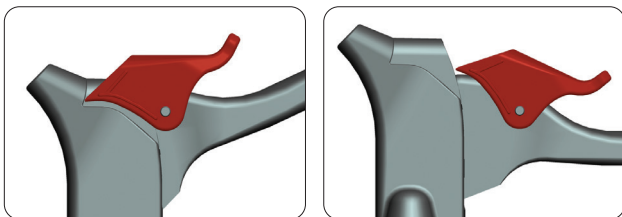

The stop lever pushes up - it has to be pushed down manually

Straight cable outlet vs. angled cable outlet

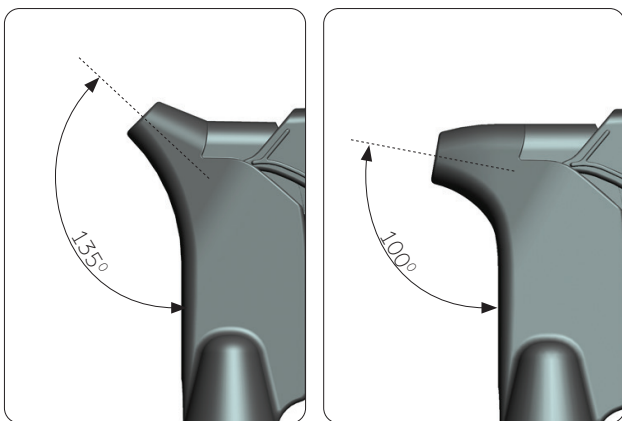

Angled cable outlet

Straight cable outlet

Brake and release handles (double function)

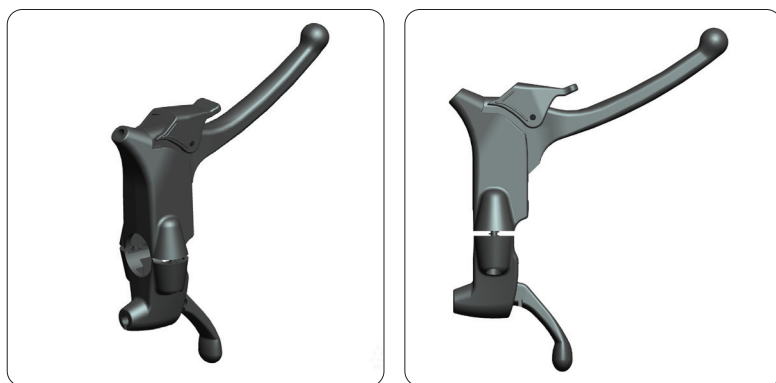

BHRH1 – Brake and release handle (double function) with angled cable outlet

- » Material: PA+GF
- » Textured surface
- » Available for Ø25 mm tube on request

| For tube diameter mm | Parking brake function | Quantity of parking brake positions | Type of screw for fitting | Color handle/levers | Part no. |
|----------------------|------------------------|-------------------------------------|---------------------------|---------------------|----------|
| Ø22 | Manual | 5 | Self tapping | Black/Black | 671028 |
| Ø22 | Manual | 5 | Normal | Black/Black | 671028A |
| Ø25 | Manual | 5 | Self tapping | Black/Black | 671058 |
| Ø22 | Auto | 5 | Self tapping | Black/Black | check |

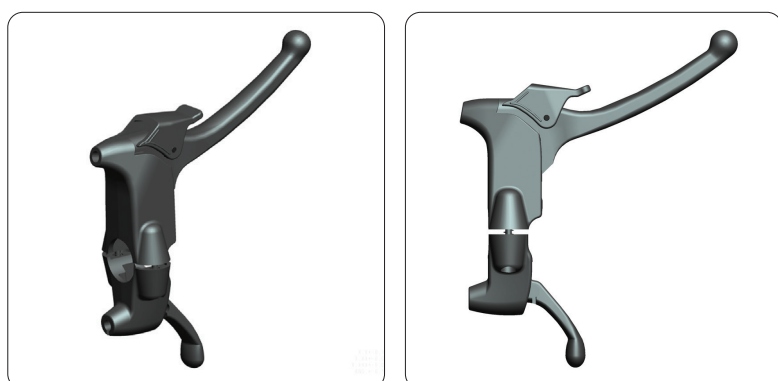

BHRH1 – Brake and release handle (double function) with straight cable outlet

- » Material: PA+GF
- » Textured surface
- » Available for Ø25 mm tube on request

| For tube diameter mm | Parking brake function | Quantity of parking brake positions | Type of screw for fitting | Color handle/levers | Part no. |
|----------------------|------------------------|-------------------------------------|---------------------------|---------------------|----------|
| Ø22 | Manual | 5 | Self tapping | Black/Black | 671041 |

Brake handles

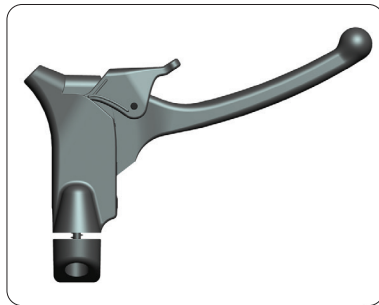

BH1 – Brake handle with angled cable outlet

- » Material: PA+GF
- » Textured surface

| For tube diameter mm | Parking brake function | Quantity of parking brake positions | Type of screw for fitting | Color handle/stop lever | Part no. |
|----------------------|------------------------|-------------------------------------|---------------------------|-------------------------|----------|
| Ø22 | Self-locking | 5 | Self tapping | Black/Black | 671022 |
| Ø22 | Manual | 5 | Self tapping | Black/Black | 671032 |
| Ø25 | Self-locking | 5 | Self tapping | Black/Black | 671009 |
| Ø25 | Manual | 5 | Self tapping | Black/Black | 671019 |

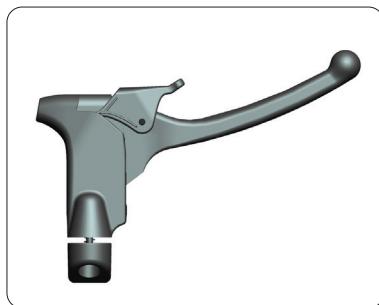

BH1 – Brake handle with straight cable outlet

- » Material: PA+GF
- » Textured surface

| For tube diameter mm | Parking brake function | Quantity of parking brake positions | Type of screw for fitting | Color handle/stop lever | Part no. |
|----------------------|------------------------|-------------------------------------|---------------------------|-------------------------|----------|
| Ø22 | Self-locking | 5 | Self tapping | Black/Black | 671020 |
| Ø22 | Manual | 5 | Self tapping | Black/Black | 671030 |
| Ø25 | Self-locking | 5 | Self tapping | Black/Black | 671021 |
| Ø25 | Manual | 5 | Self tapping | Black/Black | 671031 |

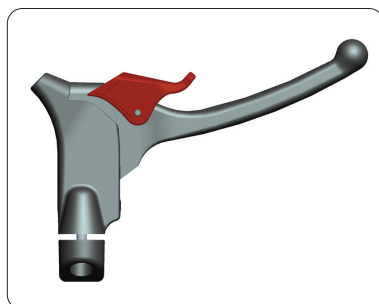

BH2 – Brake handles with angled cable outlet

- » Material: PA+GF
- » Textured surface
- » Version with automatic brake function for Ø25mm tube is available on request

| For tube diameter mm | Parking brake function | Quantity of parking brake positions | Type of screw for fitting | Color handle/stop lever | Part no. |
|----------------------|------------------------|-------------------------------------|---------------------------|-------------------------|----------|
| Ø22 | Manual | 5 | Normal | Black/Red | 671026 |
| Ø22 | Self-locking | 5 | Self tapping | Black/Red | 671029 |
| Ø25 | Manual | 5 | Normal | Black/Red | 671027 |

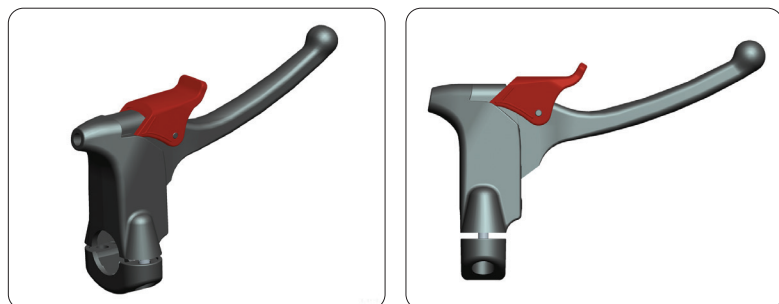

BH2 – Brake handles with straight cable outlet

- » Material: PA+GF
- » Textured surface
- » Version with automatic brake function for Ø25mm tube is available on request

| For tube diameter mm | Parking brake function | Quantity of parking brake positions | Type of screw for fitting | Color handle/stop lever | Part no. |
|----------------------|------------------------|-------------------------------------|---------------------------|-------------------------|----------|
| Ø22 | Manual | 5 | Self tapping | Black/Red | 671042 |
| Ø22 | Self-locking | 5 | Self tapping | Black/Red | 671039 |
| Ø25 | Manual | 5 | Self tapping | Black/Red | 671043 |

Release handles

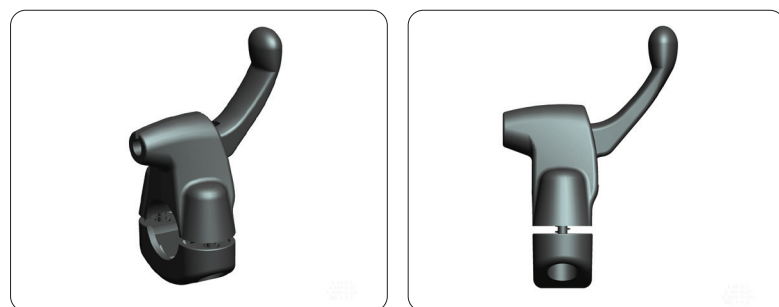

RH1 – Release handle

- » Material: PA+GF
- » Textured surface
- » Available for Ø25 mm tube on request

| For tube diameter mm | Type of screw for fitting | Color handle/lever | Part no. |
|----------------------|---------------------------|--------------------|----------|
| Ø22 | Self tapping | Black/Black | 671034 |

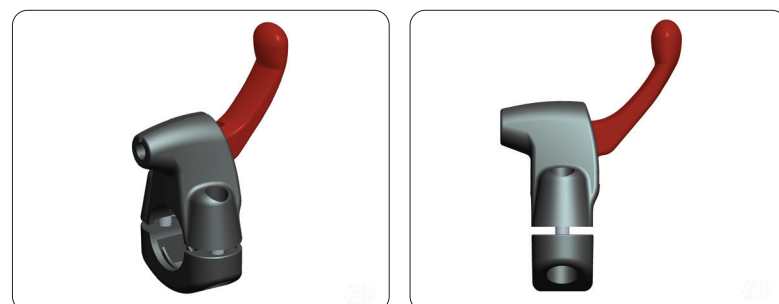

RH2 – Release handle

- » Material: PA+GF
- » Textured surface
- » Available for Ø25 mm tube on request
- » NB – color of handle is silver – not black as on the illustration!

| For tube diameter mm | Type of screw for fitting | Color handle/lever | Part no. |
|----------------------|---------------------------|--------------------|----------|
| Ø22 | Normal | Silver/Red | 671044 |



RH3 – Release handle

- » Material: PA+GF
- » Textured surface
- » Available for Ø25 mm tube on request

| For tube diameter mm | Type of screw for fitting | Color handle/lever | Part no. |
|----------------------|---------------------------|--------------------|----------|
| Ø22 | Normal | Silver/Blue | 671045 |
| Ø22 | Normal | Black/Blue | 67103B |



RH4 – Release handle

- » Material: PA+GF
- » Textured surface
- » Available for Ø25 mm tube on request

| For tube diameter mm | Type of screw for fitting | Color handle/lever | Part no. |
|----------------------|---------------------------|--------------------|----------|
| Ø22 | Normal | Black/Black | 67101E |

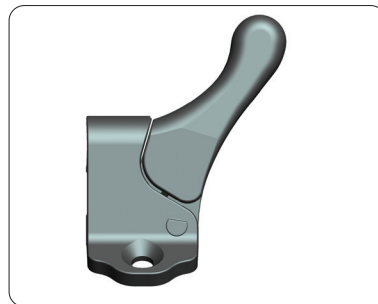

RH5 – Release handle

- » Material handle: PA+GF
- » Material "holder": aluminium
- » Textured surface
- » Recommended for tube diameter Ø22-Ø27mm

| For tube diameter mm | Color handle/holder | Part no. |
|----------------------|---------------------|----------|
| Ø22 | Black/Black | 671105 |



omobic by mbl

You can see our selection of wheel locks for active chairs in the Omobic catalogue!