



MBL line Pushrims & pushrim covers

mb.l

Pushrims & pushrim covers

Pushrim fitting options	3
Aluminium pushrims with rivnuts	5
Aluminium pushrims with splices	6
Coated aluminium pushrims	7
Aluminium pushrims with knobs	8
Ergonomic pushrims	8
Stainless steel pushrims	10
Silicone covers	11

Pushrim fitting options

Fitting options – Double wall rims

TYPE A:

Pushrim with splices fitted on rim with rivnuts



- » The pushrim can be exchanged without removing the tyre and the tube

Fitting options – Single wall rims

TYPE B:

Pushrim with splices fitted with screw and lock nut

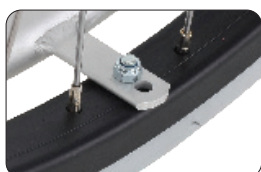

- » necessary to remove tyre and tube to exchange pushrim

TYPE C:

Pushrim with rivnuts fitted with anchor-plates

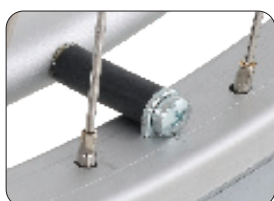

- » Distance between pushrim and rim is 17 mm as standard. Other lengths on request

Examples of ergonomic pushrims in our Omobic offer

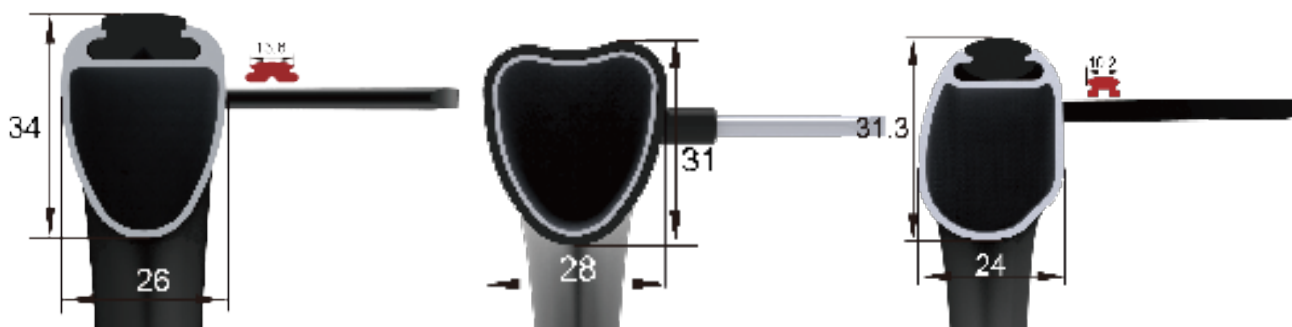

Aluminium pushrims with rivnuts

black powdercoated, silver anodized or black anodized



- » New in red, also available in k
- » Ø19 x 1,25
- » 4 or 6 rivnuts
- » Ø19,6 x 1,25
- » Black powdercoated, silver anodized or black anodized

Wheel Size	SD fitting distance mm	Fit rim types	Weight g	Fitting	Black powdercoated	Silver anodized	Black anodized
20"	426	SW1	-	4 rivnuts	322001	322002	-
24"	515	SW1	-	4 rivnuts	-	322402	322442
22"	464	SW1	-	6 rivnuts	322251	322252	-
24"	515	SW1	-	6 rivnuts	322451	322452	322450
26"	565	SW1	-	6 rivnuts	322651	322652	-

Sign up to our newsletter at mbl.dk to stay updated!



Aluminium pushrims with splices

silver anodized or black anodized

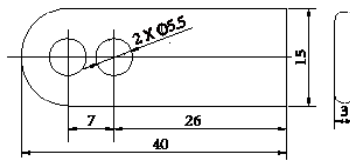

- » New in red, also available in k
- » Ø19 x 1,25
- » Splices (392115) with two holes
- » Extra long splices used for pushrims which fit extra wide wheels
- » Splices can be adjusted +/- 2 mm

Wheel Size	SD fitting distance mm	Fit rim types	Weight g	Fitting	Splice Type	Silver anodized	Black anodized
22"	466	DW4 & DW7	311	6 splices	392115	342255	342256
22"	472	SW1	315	6 splices	392115	342251	342252
22"	472	SW1		6 splices	-	342251	342257
24"	510	DW2	338	6 splices	392115	344458	342458
24"	517	DW4 & DW7	343	6 splices	392115	342455	342456
24"	523	SW1		4 splices	-	342401	342402
24"	523	SW1	350	6 splices	392115	342451	342452
25"	530	DW2	351	6 splices	392115	342568	342567
25"	542	SW1	359	6 splices	392115	342561	342558
26"	560	DW2	-	6 splices	392115	-	-
26"	567	DW4 & DW7	374	6 splices	392115	342655	342656
26"	573	SW1	378	6 splices	392115	342651	342652

Coated aluminium pushrims for extra grip



Coated pushrim with splices

- » Ø19 x 1,25
- » Thickness of dipping app 1 mm
- » Fitting with splices (392115) with two holes
- » Splices can be adjusted +/- 2 mm

Wheel size	SD fitting distance mm	Fit rim types	Weight g	Fitting	Standard Grip
22"	466	DW4 & DW7	-	6 splices	342214
22"	472	SW1	-	6 splices	342254
24"	510	DW2	-	6 splices	34249F
24"	517	DW4 & DW7	-	6 splices	342489
24"	523	SW1	-	6 splices	342454
25"	530	DW2	-	6 splices	3425D5



Coated pushrim with rivnuts

- » Ø19 x 1,25
- » Thickness of dipping app 1 mm
- » Fitting with rivnuts

Wheel size	SD fitting distance mm	Fit rim types	Weight g	Fitting	Standard Grip
20"/451	426	SW1		4	322010
26"/590	565	SW1		4	-
20"/451	426	SW1		6	322053
22"/489	464	SW1		6	322260
24"/540	515	SW1		6	322460

Aluminium pushrims with knobs



Aluminium pushrim with 8 knobs and splices

- » Ø24 x 1,25
- » 4 or 6 splices
- » Note: the knobs can be adjusted to different angles
- » Length of knobs: 20 mm
- » Black powder coated

Wheel size	SD fitting distance mm	Fit MBL rim types	Weight (g)	Fitting	Part. no.
24"	524	SW1	-	6 splices	342474

Ergonomic pushrims

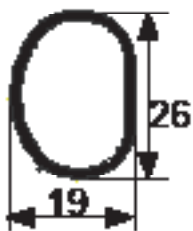

Ergonomic plastic pushrim with rivnuts

- » Good grip and comfortable to touch also in cold weather
- » Generates heat when braking at high speed
- » Ø19 x 26
- » Non allergic and insulates against cold
- » 4 or 6 rivnuts

Wheel size	SD fitting distance mm	Fits MBL rim type	Weight (g)	Fitting	Part no.
20"	426	SW1	-	4 rivnuts	312002
22"	464	SW1	-	4 rivnuts	312202
24"	515	SW1	-	4 rivnuts	312402
20"	426	SW1	-	6 rivnuts	312052
22"	464	SW1	-	6 rivnuts	312252
24"	515	SW1	-	6 rivnuts	312452
26"	565	SW1	-	6 rivnuts	312652

Carbon solutions for rehab industry

**Skilfully engineered. Delivered fast.
Quality you can trust.**



View the video about
our carbon competencies

Stainless steel pushrims

brushed or polished

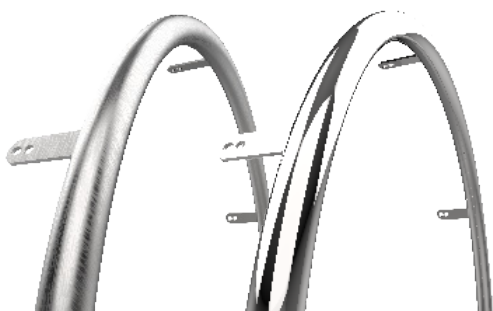

Stainless steel pushrims with splices

- » Very durable and scratch resistant
- » 6 splices (392169), 2 mm thick
- » Splices can be adjusted +/- 2 mm
- » Ø19 mm

Wheel size	SD fitting distance mm	Fit Omobic rim types	Weight g	Fitting	Polished	Brushed
22"	472	SW1	676	6 splices	352272	352262
24"	510	DW2	727	6 splices	352478	on request
24"	517	DW4 & DW7	736	6 splices	352458	on request
24"	523	SW1	745	6 splices	352472	352462
25"	535	DW4 & DW7	763	6 splices	352558	on request
26"	573	SW1	816	6 splices	352672	352662
26"	567	DW4 & DW7	803	6 splices	352658	on request



Stainless steel pushrims with rivnuts

- » Very durable and scratch resistant
- » 4 or 6 rivnuts
- » Ø19 mm

Wheel size	SD mm	Fits MBL rim type	Fitting	Polished	Brushed
20"	426	SW1	6 rivnuts	332054	332055
22"	464	SW1	6 rivnuts	332254	332205
24"	515	SW1	6 rivnuts	332454	332455
26"	565	SW1	6 rivnuts	332654	332655

Silicone covers with ribbed or smooth surface



Ribbed surface



Smooth surface

- » Pushrim covers in silicone are a perfect solution for many wheelchair users
- » Can be used onto your existing pushrim to improve grip and comfort
- » Easy to mount in seconds without using any tools
- » These covers are ideal for chipped and damaged pushrims
- » Insulate from cold steel/aluminium
- » Provides better control over a chair as well as better efficiency of propulsion and braking
- » Do not cause allergic reaction
- » Other dimensions are available on request

Pushrim dimension Ød x Ød (mm)	Wheel size	Weight (g)	Part no. black ribbed (1 pcs)	Part no. black smooth (1 pcs)
Ø16-19 x Ø438-445	20"	400	382032	382022
Ø16-19 x Ø470-477	22"	450	382232	382222
Ø16-19 x Ø478-485	22"	450	382233	382223
Ø16-19 x Ø486-493	22"	450	-	382224
Ø16-19 x Ø494-501	22"	450	-	382225
Ø16-19 x Ø511-518	24"	500	382431	382421
Ø16-19 x Ø519-525	24"	500	382432	382422
Ø16-19 x Ø526-532	24"	500	382433	382423
Ø16-19 x Ø533-539	24"	500	382434	382424
Ø16-19 x Ø561-570	26"	550	-	382621
Ø16-19 x Ø571-580	26"	550	-	382622
Ø16-19 x Ø581-590	26"	550	-	382623

Would you like to see and learn more?

MBL website



Our videos on YouTube



Check our Facebook



Connect with us on LinkedIn



Connect with us on WeChat



Other product categories:

Front wheels 4"-8"



Rear wheels 12"-26"



Tyres, PU tyres, tubes , infills & tyres
w insert for manual wheelchairs 6"-26"



Front forks & bearing housings



QR axles and bushings



Hand brakes, brake handles & release handles



Other wheelchair components & accessories



Foam parts, supports & textiles



Tyres, tubes and tyres with infills
for power wheelchairs



MBL Denmark

MBL a/s

Glarmestervej 18 B, St. Th.

8600 Silkeborg

CVR: 12825242

contact@mbl.dk

MBL Poland

MBL Poland Sp. z o.o.

Sulejowska 45d

97-300 Piotrkow Trybunalski

VAT No: 7710008003

Tel: +48 44 73 24 100

contact@mbl.pl

MBL China

MBL (Xiamen) Co. Ltd.

No.289 Wengjiao Road Xinyang

Industrial District Haicang

361022 Xiamen

Tel: +86 592 5961 896

contact@mbl.com.cn

March 2026